

SHRINK FIT CHUCK

- Made of high-temperature steel and fit for High frequency heating machine.
- For clamping cutting tools with cylindric shank tolerance h6
- High tool-gripping strength and machining accuracy
- 360 degree concentric clamping without set screws, collets.
- Engineered to produce the high degree of balance available
- With indicating line for shank depth of cutter.

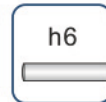

Order No.	Model	Shank	Size(mm)					Screw
			dm	D1	D2	L	H	
132-02-401	JT40-SFX03-80	SK40-AD	3	10	-	80	10	-
132-02-402	JT40-SFX04-80	SK40-AD	4	10	-	80	12	-
132-02-403	JT40-SFX05-80	SK40-AD	5	10	-	80	15	-
132-02-404	JT40-SFX06-80	SK40-AD	6	21	27	80	36	S005014C
132-02-405	JT40-SFX06-120	SK40-AD	6	21	27	120	36	S005014C
132-02-406	JT40-SFX06-160	SK40-AD	6	21	32	160	36	S005014C
132-02-407	JT40-SF08-80	SK40-AD	8	21	27	80	36	S006014C
132-02-408	JT40-SF08-120	SK40-AD	8	21	27	120	36	S006014C
132-02-409	JT40-SF08-160	SK40-AD	8	21	32	160	36	S006014C
132-02-410	JT40-SF10-80	SK40-AD	10	24	32	80	42	S008014C
132-02-411	JT40-SF10-120	SK40-AD	10	24	32	120	42	S008014C
132-02-412	JT40-SF10-160	SK40-AD	10	24	34	160	42	S008014C
132-02-413	JT40-SF12-80	SK40-AD	12	24	32	80	47	S008014C
132-02-414	JT40-SF12-120	SK40-AD	12	24	32	120	47	S008014C
132-02-415	JT40-SF12-160	SK40-AD	12	24	34	160	47	S008014C
132-02-416	JT40-SF14-80	SK40-AD	14	27	34	80	47	S008014C
132-02-417	JT40-SF14-120	SK40-AD	14	27	34	120	47	S008014C
132-02-418	JT40-SF14-160	SK40-AD	14	27	42	160	47	S008014C
132-02-419	JT40-SF16-80	SK40-AD	16	27	34	80	50	S012014C
132-02-420	JT40-SF16-120	SK40-AD	16	27	34	120	50	S012014C
132-02-421	JT40-SF16-160	SK40-AD	16	27	42	160	50	S012014C
132-02-422	JT40-SF18-80	SK40-AD	18	33	42	80	50	S012014C
132-02-423	JT40-SF18-120	SK40-AD	18	33	42	120	50	S012014C
132-02-424	JT40-SF18-160	SK40-AD	18	33	50	160	50	S012014C
132-02-425	JT40-SF20-80	SK40-AD	20	33	42	80	52	S016016C
132-02-426	JT40-SF20-120	SK40-AD	20	33	42	120	52	S016016C
132-02-427	JT40-SF20-160	SK40-AD	20	33	50	160	52	S016016C
132-02-428	JT40-SF25-100	SK40-AD	25	44	50	100	58	S016016C
132-02-429	JT40-SF25-120	SK40-AD	25	44	50	120	58	S016016C
132-02-430	JT40-SF25-160	SK40-AD	25	44	50	160	58	S016016C
132-02-501	JT50-SFX06-80	SK50-AD	6	21	27	80	36	S005014C
132-02-502	JT50-SFX06-120	SK50-AD	6	21	27	120	36	S005014C
132-02-503	JT50-SFX06-160	SK50-AD	6	21	32	160	36	S005014C
132-02-504	JT50-SF08-80	SK50-AD	8	21	27	80	36	S006014C
132-02-505	JT50-SF08-120	SK50-AD	8	21	27	120	36	S006014C
132-02-506	JT50-SF08-160	SK50-AD	8	21	32	160	36	S006014C
132-02-507	JT50-SF10-80	SK50-AD	10	24	32	80	42	S008014C
132-02-508	JT50-SF10-120	SK50-AD	10	24	32	120	42	S008014C
132-02-509	JT50-SF10-160	SK50-AD	10	24	34	160	42	S008014C
132-02-510	JT50-SF12-80	SK50-AD	12	24	32	80	47	S008014C
132-02-511	JT50-SF12-120	SK50-AD	12	24	32	120	47	S008014C
132-02-512	JT50-SF12-160	SK50-AD	12	24	34	160	47	S008014C
132-02-513	JT50-SF14-80	SK50-AD	14	27	34	80	47	S008014C
132-02-514	JT50-SF14-120	SK50-AD	14	27	34	120	47	S008014C
132-02-515	JT50-SF14-160	SK50-AD	14	27	42	160	47	S008014C
132-02-516	JT50-SF16-80	SK50-AD	16	27	34	80	50	S012014C
132-02-517	JT50-SF16-120	SK50-AD	16	27	34	120	50	S012014C
132-02-518	JT50-SF16-160	SK50-AD	16	27	42	160	50	S012014C
132-02-519	JT50-SF18-80	SK50-AD	18	33	42	80	50	S012014C
132-02-520	JT50-SF18-120	SK50-AD	18	33	42	120	50	S012014C
132-02-521	JT50-SF18-160	SK50-AD	18	33	51	160	50	S012014C
132-02-522	JT50-SF20-80	SK50-AD	20	33	42	80	52	S016016C
132-02-523	JT50-SF20-120	SK50-AD	20	33	42	120	52	S016016C
132-02-524	JT50-SF20-160	SK50-AD	20	33	51	160	52	S016016C
132-02-525	JT50-SF25-100	SK50-AD	25	44	53	100	58	S016016C
132-02-526	JT50-SF25-120	SK50-AD	25	44	53	120	58	S016016C
132-02-527	JT50-SF25-160	SK50-AD	25	44	60	160	58	S016016C
132-02-528	JT50-SF32-100	SK50-AD	32	44	53	100	58	S016016C
132-02-529	JT50-SF32-120	SK50-AD	32	44	53	120	58	S016016C
132-02-530	JT50-SF32-160	SK50-AD	32	44	60	160	58	S016016C

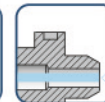